

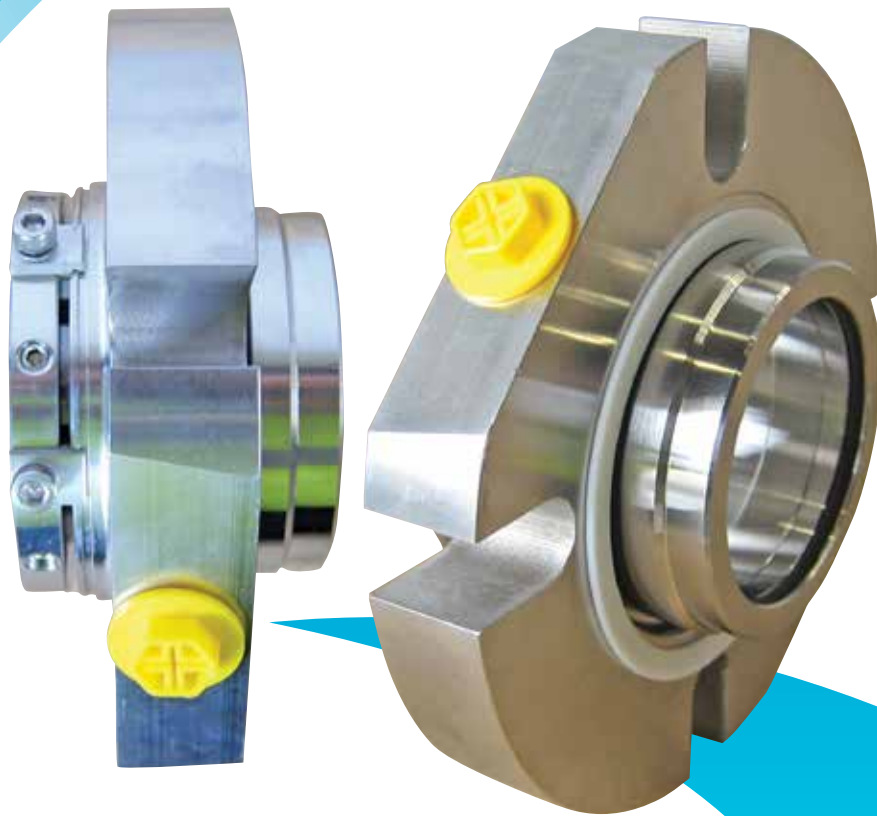

**Series MS
Mechanical Seals
F365 Cartridge Seals**



MECHANICAL SEALS

F365 Series - Cartridge Seals

The Aquaplus F365 is a robust, bi-directional, multi-spring, single balanced cartridge mechanical seal. The seal is a hydraulically balanced cartridge seal with protected multi springs, it has cooler running faces, longer life and can operate at higher temperatures.

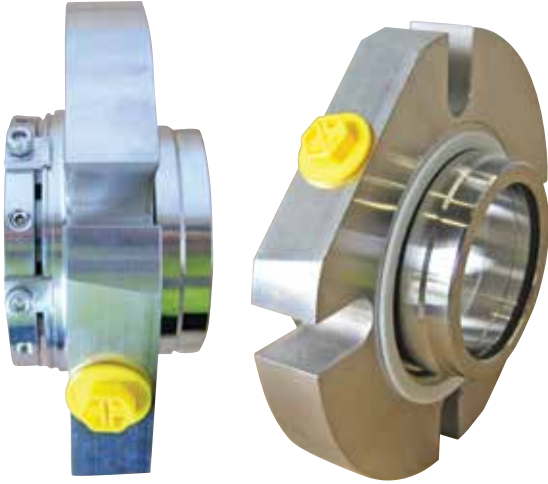

Features

- Cartridge design
- Easy installation
- Hydraulically balanced seal faces
- Springs isolated from the process liquid
- Auto aligning seal faces
- No fretting
- Full faced gland plate

Options

- Flushing port (Standard)
- Quenching ports
- Or both

Applications

Major use: Oil, Water, chemicals, sludges, slurries in such industries as Wastewater treatment, Mining, Mineral processing, Pulp & Paper, Food processing, Marine and any other general application.

Operating Limitations

- Temperature: -40°C to +230°C
- Pressure in seal chamber: up to 25 Bar
- Linear velocity: up to 25 M/Sec.

Materials

- Metal components
 - Standard SUS316
 - Options Hastelloy, Duplex 2205
- Seal faces
 - Standard SSiC V's SSiC (Sintered)
 - Silicon Carbide
 - Options RSiC, TC, Carbon, Ceramic
- Elastomers
 - Standard FPM
 - Options Kalrez, NBR, EPDM, PTFE

Technical Data

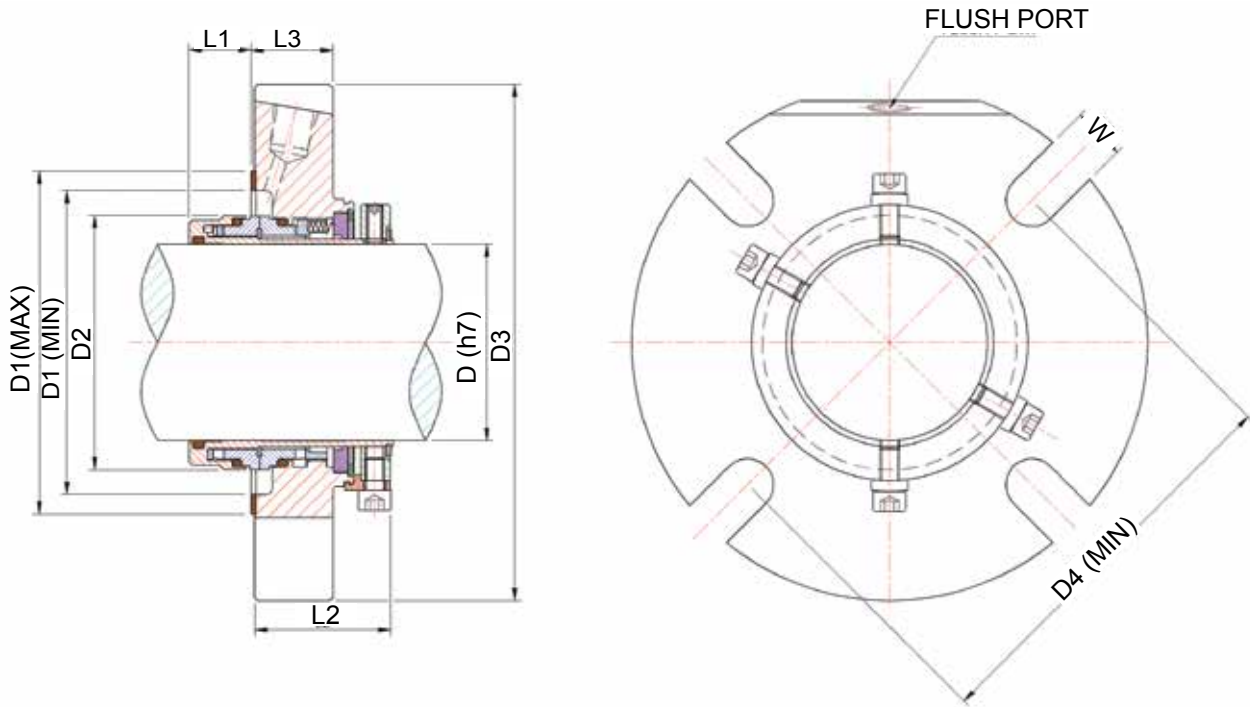

D Shaft ID		D1 Stuffing Box ID				D2		D3		L1		L2		L3		W		PCD (D4)		Flushing port size
Inch	mm	MIN	MAX	Inch	mm	Inch	mm	Inch	mm	Inch	mm	Inch	mm	Inch	mm	Inch	mm	Inch	mm	
	24		40		46		41		105		18.35		44		26		12		70	3/8" BSP-f
1.000	25	1.570	40	1.850	47	1.535	39	3.937	100	0.650	16.5	1.732	44	0.984	25	0.47	12	2.756	70	3/8" BSP-f
1.125	28	1.690	43	1.970	50	1.693	43	4.016	102	0.650	16.5	1.732	44	0.984	25	0.47	12	2.953	75	3/8" BSP-f
	30		44		53		44		102		17		44		25		12		78	3/8" BSP-f
1.250	32	2.010	51	2.170	55	1.929	49	4.134	105	0.669	17	1.732	44	0.984	25	0.47	12	3.071	78	3/8" BSP-f
	33		50		55		50		105		17.5		44		25		12		78	3/8" BSP-f
1.375	35	2.010	51	2.280	58	1.929	49	4.724	120	0.689	17.5	1.732	44	0.984	25	0.47	12	3.228	82	3/8" BSP-f
1.500	38	2.362	60	2.560	65	2.185	55.5	5.039	128	0.728	18.5	1.732	44	0.984	25	0.47	12	3.504	89	3/8" BSP-f
	40		60		65		57		128		18.5		44		25		12		89	3/8" BSP-f
1.625		2.375		2.560		2.185		5.039		0.728		1.732		0.984		0.47		3.504		3/8" BSP-f
	42		63		68		58		128		18.5		44		25		12		89	3/8" BSP-f
	43		63		68		60		128		18.5		44		26		12		92	3/8" BSP-f
1.750	45	2.500	70	2.950	75	2.437	61.9	5.000	127	0.728	18.5	1.732	44	0.984	25	0.47	12	3.819	97	3/8" BSP-f
1.875	48	2.625	71	2.950	75	2.563	65.1	5.118	130	0.728	18.5	1.732	44	0.984	25	0.47	12	3.819	97	3/8" BSP-f
2.000	50	2.795	71	2.950	75	2.677	68	5.827	148	0.728	18.5	1.732	44	0.984	25	0.47	12	3.898	99	3/8" BSP-f
	53		75		85		72		168		19		44		25		12		109	3/8" BSP-f
2.125		2.875		3.125		2.811		5.906		0.748		1.732		0.984		0.63		4.331		3/8" BSP-f
	55		75		77		72		148		19		44		25		16		110	3/8" BSP-f
2.250		3.000		3.250		2.937		6.220		0.748		1.732		0.984		0.63		4.250		3/8" BSP-f
2.375	60	3.228	82	3.740	95	3.071	78	6.220	158	0.748	19	1.732	44	0.984	25	0.63	16	4.843	123	3/8" BSP-f
2.500	63	3.275	86	3.620	92	3.311	84.1	6.496	165	0.748	19	1.811	46	0.984	25	0.63	16	4.921	125	3/8" BSP-f
2.625	65	3.465	88	3.660	93	3.150	80	6.929	176	0.768	19.5	1.811	46	0.984	25	0.63	16	4.921	125	3/8" BSP-f
2.750	70	3.661	93	3.940	100	3.228	82	6.929	176	0.768	19.5	1.811	46	0.984	25	0.63	16	5.315	135	3/8" BSP-f
2.875		3.875		4.170		3.346		7.402		0.866		1.811		1.102		0.63		5.512		3/8" BSP-f
3.000	75	4.016	102	4.170	106	3.346	85	7.402	188	0.866	22	1.811	46	1.102	28	0.73	18.5	5.512	140	3/8" BSP-f
3.125	80	4.213	107	4.450	113	3.425	87	7.874	200	0.866	22	1.811	46	1.102	28	0.73	18.5	5.709	145	3/8" BSP-f
3.250		4.375		4.687		3.543		8.189		0.925		1.811		1.220		0.73		6.102		3/8" BSP-f
3.375	85	4.409	112	4.720	120	3.543	90	8.189	208	0.925	23.5	1.811	46	1.220	31	0.73	18.5	6.220	158	3/8" BSP-f
3.500	90	4.606	117	4.920	125	3.622	92	8.661	220	1.024	26	1.811	46	1.220	31	0.73	18.5	6.457	164	3/8" BSP-f
3.625		4.750		5.062		3.701		8.661		1.024		1.811		1.220		0.73		6.457		3/8" BSP-f
3.750	95	4.803	122	5.120	130	3.701	94	8.661	220	1.024	26	1.811	46	1.220	31	0.73	18.5	6.575	167	3/8" BSP-f
3.875		5.000		5.312		4.937				1.024		1.811		1.220		0.73		6.575		3/8" BSP-f

All content is subject to change without notice.

Aquaplus Product Range

ESD Series – End Suction DIN (24255) Pumps

ESI Series – End Suction ISO (2585) Pumps

SP Series – Self Priming Pumps

SD Series – Submersible Dewatering Pumps

SS Series – Submersible Sewerage Pumps

ARJ Series – Aerators (Jet)

ARS Series – Aerators (Submersible)

AD Series – Air Diaphragm Pumps

FRM Series – Flexible Rising Main (Borehole Pump Hose)

MS Series – Mechanical Seals (Single Spring & Cartridge)

We are also able to provide Progressive Cavity, Peristaltic Pumps, Split Case Pumps and Magnetic Drive Pumps.

The logo for Aquaplus, featuring the word "Aquaplus" in a stylized, blue, italicized font with a wave-like underline.

EXCLUSIVELY DISTRIBUTED BY

The logo for Malcolm Thompson Pumps, featuring a blue wave icon to the left of the text "MALCOLM THOMPSON PUMPS" in a bold, sans-serif font.

1800 733 687

www.mtp.com.au | mtp@mtp.com.au

For information on these products or for any specialised requirements please contact your local Aquaplus distributor or visit our website at www.aquapluspumps.com.au